

BV5000 Ball Valve Repair Machine

FEATURES ■ SETUP & OPERATION
COMPONENTS & ACCESSORIES ■ TECHNICAL DATA

The Climax BV5000 Ball Valve Repair Machine conducts in-place repairs on welded-in 5 and 6 inch (127 and 152 mm) ball valves.

Compact and lightweight

- Compact design allows use in extremely tight spaces where other machines won't fit.
- Lightweight design enables easy operation and use.

Easy to set up and operate

- Modular components allow full setup in one hour or less.
- Machine can be installed without removing valve studs; studs are not used for alignment.
- "Ball Lock" system allows removal and re-installation of the machine without the need for additional setup.

Powerful and Versatile

- Robust feed system allows for roughing and finishing in all ranges.
- Machines both 5 and 6 inch (127.0 and 152.4 mm) valves.
- Machining diameter and feed rate can be preset before installing machine into the valve.
- Feed rate is infinitely variable from 0.003 to 0.012 inches (0.076 to 0.30 mm) per revolution, and can be adjusted during machining.
- "Rapid Retract" feature saves time by retracting the cutting tool to the start position using a pneumatic turbine wheel.
- Measuring tool allows quick and accurate measurement to the center line of the valve, in 0.0005" (0.013 mm) increments.

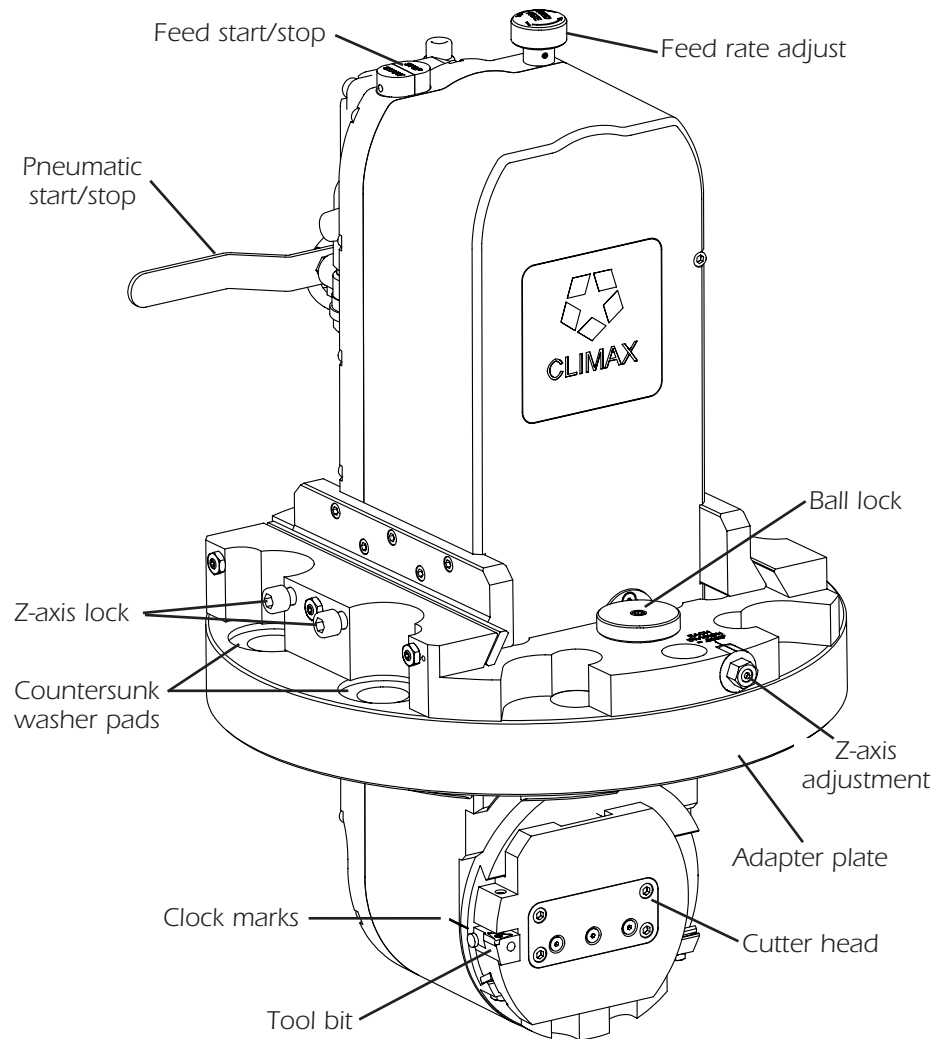

CLIMAX[®]
Portable Machine Tools, Inc.

Specifications

	US	Metric
Application range	5 or 6 inch valve	127.0 or 152.4 mm valve
Max. depth of cut	0.030 inches	0.76 mm
Feed rate	infinitely variable, from 0.003 to 0.012 inches per revolution	infinitely variable, from 0.076 to 0.305 mm per revolution
Spindle speed	130 RPM	130 RPM
Min. supply air pressure	75 psi	517.1 kPa
Operating weight	38 lbs	17.2 kg
Shipping weight	75 lbs	34.0 kg

Dimensions in inch (mm)

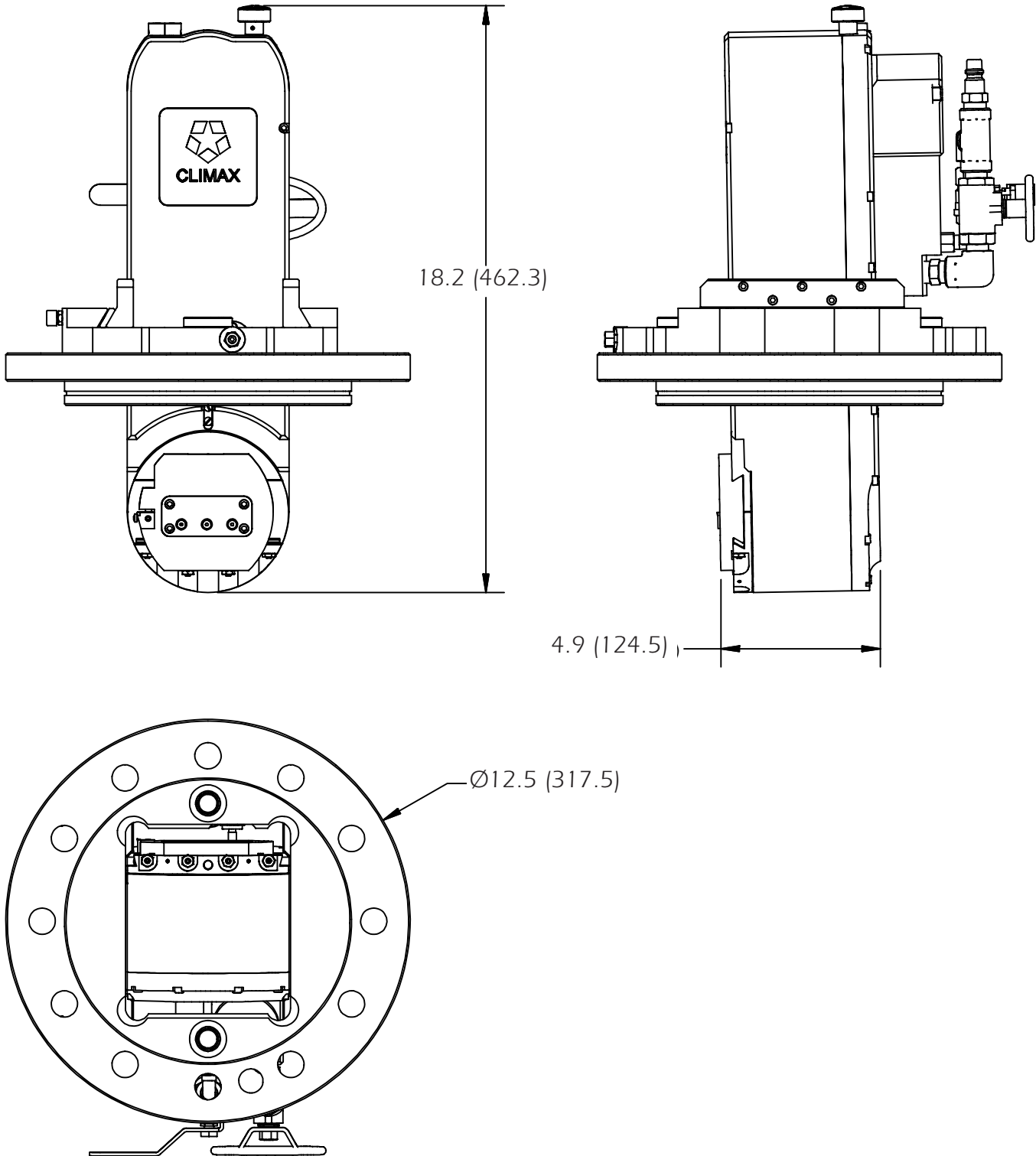

Dimensions in inch (mm)

BV5000 Ball Valve Machine

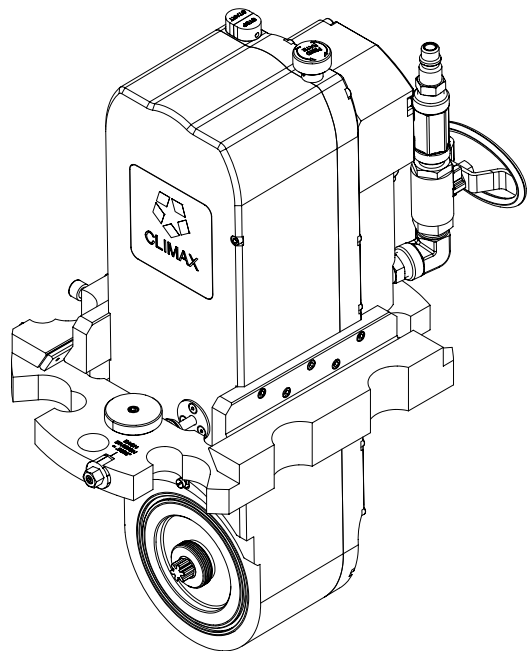

Measuring Tool*

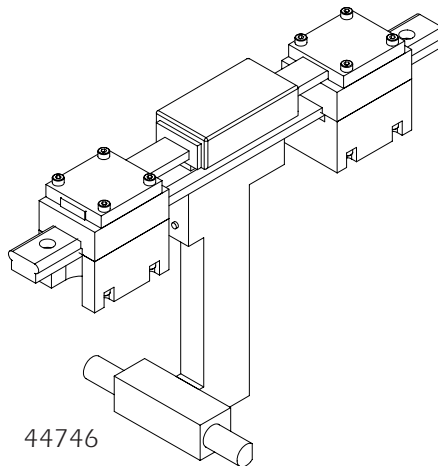

Adapter Plate, 5 and 6 inches (127 and 152.4 mm)

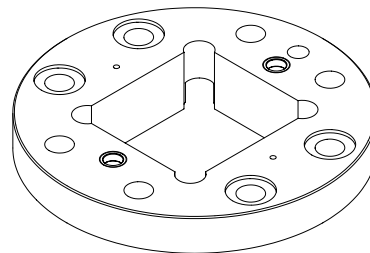

5 inch (127.0 mm)
6 inch (152.4 mm)

Interchangeable Tool Heads, 5 and 6 inches (127 and 152.4 mm)

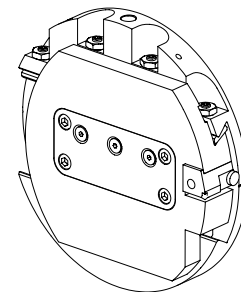

Presetting Stand

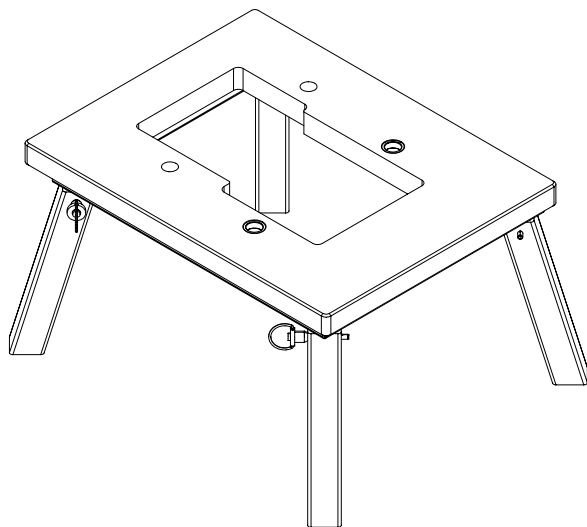

Complete Machine includes:

BV5000 Ball Valve Repair Machine	44503
(includes interchangeable tool heads for 5 and 6 inch (127.0 and 152.4 mm) valves.)	
Presetting Stand	
5 inch (127.0 mm) adapter plate	
6 inch (152.4 mm) adapter plate	
Pneumatic conditioning unit	

Unit comes with tool kit, spares (pkg of 5 carbide inserts 43809), and instruction manual, and is packed in a durable molded container

* **Measuring Tool sold separately** 44746

Specifications subject to change without notice.
Drawings for reference only, not shown to scale.

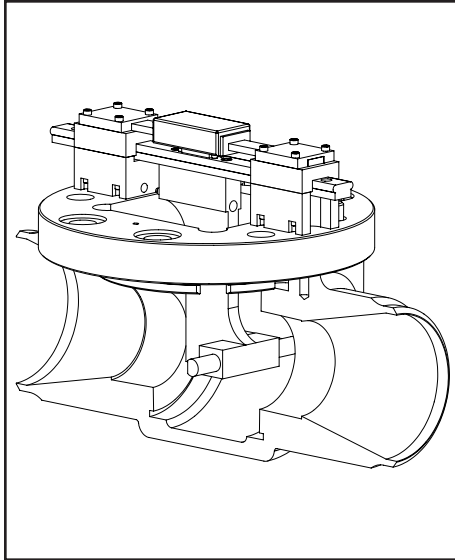

1. Ready the workpiece to be machined, and measure the workpiece

Attach the adapter plate to the valve, and center with the measuring device. Secure the adapter plate.

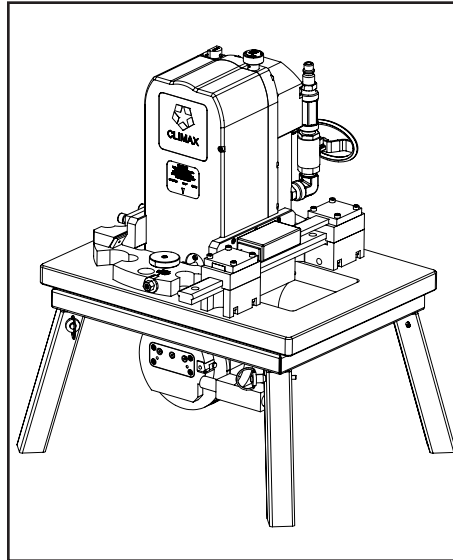

2. Preset the Machine

Use the presetting stand to preset the machine for the initial cut.

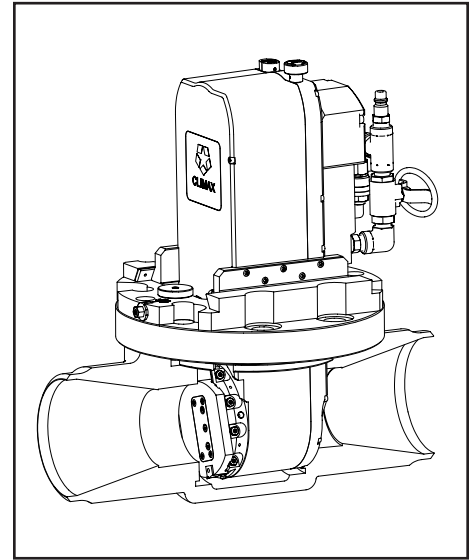

3. Machine the First Valve Face

Remove the machine from the presetting stand, and insert it into the valve.

Begin the machining process.

When machining is complete, use the rapid retract feature to retract the tool.

Stop the machine, disengage ball locks, and remove it from the valve.

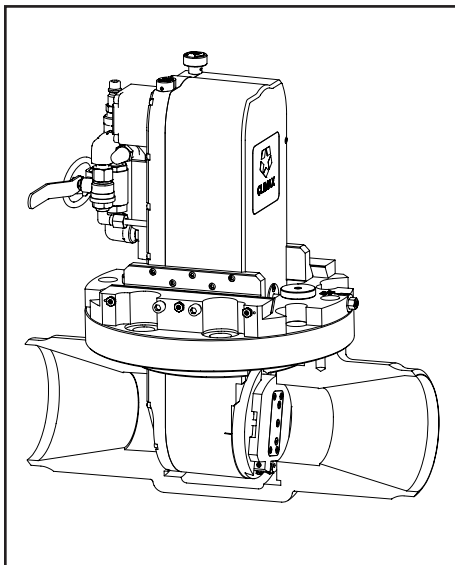

4. Machine the Second Valve Face

Rotate the machine and re-insert it into the valve to machine the opposite valve face.

Stop the machine, disengage ball locks, and remove it from the valve.

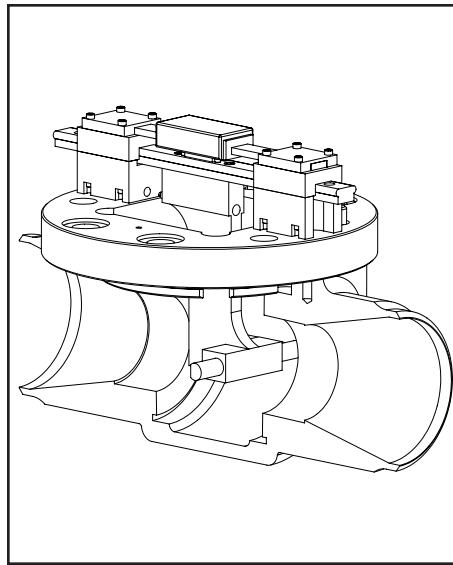

5. Measure Result

Re-insert the measuring device into the valve, and note measurement.

6. Preset Machine for Final Cut

Repeat steps 2 through 4 to perform final cut.

Climax Portable Machine Tools Worldwide Manufacturing, Sales & Rental Facilities



Call Climax for:

Rentals

With six locations in the USA, two in Canada, one in Europe, and one in Asia, you are never far away from a Climax portable machine tool.

Special Projects

Climax has been solving complicated on-site machining problems for our customers since 1964.

On-site Training

Need some refresher courses in setting up and operating your Climax machine tool?

Call us. We'll bring the solution to you.

BV5-Elec 0206

Corporate Headquarters

Climax Portable Machine Tools, Inc.
2712 E. Second Street
Newberg, Oregon 97132 USA
Worldwide Telephone: 503.538.2185
N. America Toll-Free: 800.333.8311
Fax: 503.538.7600
Email: info@cpmt.com

European Headquarters

Climax GmbH
Willi - Bleicher - Strasse 11
52353 Düren, Germany
Telephone: (+49) (0) 2421.9177.0
Fax: (+49) (0) 2421.9177.29
Email: info.de@cpmt.com

Houston Sales Office

Climax Portable Machine Tools, Inc.
16823 Highway 35
Pearland, TX 77581 USA
Telephone: 281.469.0429



CLIMAX®
Portable Machine Tools, Inc.

www.cpmt.com